



SPARE PARTS EXPLODED VIEW  
STORAGE ELECTRIC WATER HEATERS

Model

**ABS ANDRIS LUX**

R8217264-02 - 07/01/2016

ABS ANDRIS LUX

Storage Electric Water Heaters

1	3100604	ABS ANDRIS LUX 10 OR	08-2015	-
2	3100605	ABS ANDRIS LUX 10 UR	08-2015	-
3	3100606	ABS ANDRIS LUX 15 OR	08-2015	-
4	3100607	ABS ANDRIS LUX 15 UR	08-2015	-
5	3100608	ABS ANDRIS LUX 30	08-2015	-
Col	Reference	Model type	Begin	End

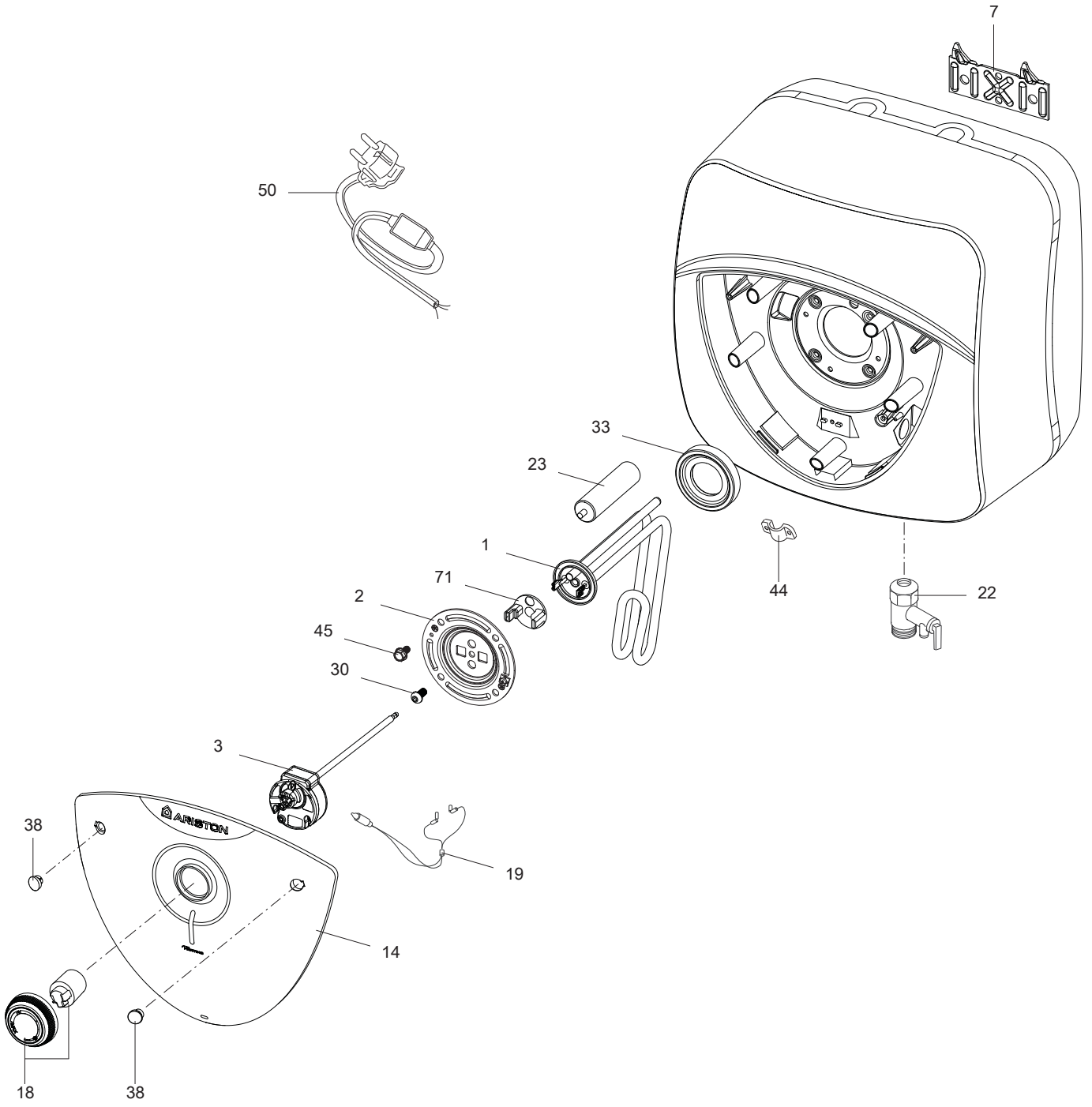



## LIST OF THE ABBREVIATIONS

HW .....	: Hot water.
CW .....	: Cold water.
C .....	: Ceramic resistance (normal heating).
Ca .....	: Ceramic resistance (accelerated heating)
TP .....	: Immersion heater.
1F .....	: With fittings.
2F .....	: Without fittings.
3F .....	: With fittings and another outlet connection.
AMI .....	: With mixing valve.
SMI .....	: Without mixing valve.
PUISS .....	: Power of th appliance.
PN .....	: Appliance with normal pression.
LP .....	: Appliance with low pression.
PV .....	: Appliance with variable power.
PF .....	: Appliance with fixed power.

## IDENTIFICATION PLATE

### SERIAL NUMBER

**6 Characters :**  
Year of manufacture 03 09 08 Manufacturing day  
Month of manufacture

**9 Characters :**  
Year of manufacture M 12 10 0606  
Month of manufacture Sequential number

**14 Characters :**  
SI-V-0B0 45 07 0001  
Sequential number  
Year of manufacture : 6 → 2004  
Month of manufacture : 25 → January 43 → July 7 → 2005  
13 → February 29 → August 8 → 2006  
32 → March 40 → September etc ...  
35 → April 38 → October  
39 → May 51 → November  
45 → June 12 → December

**15 Characters :**  
Year of manufacture 02 11 00001 007843  
Month of manufacture Code appareil  
Sequential number

**21 Characters :**  
3200050 XX 08115 0000001  
Product reference Sequential number  
Year (08) / Manufacturing day (115)

**22 Characters :**  
3200050 XX 070115 0000001  
Product reference Sequential number  
Year (07) / Month (01) / Manufacturing day (15)